

Simpatico

SIMPATICO OFFERING A FINE COLLECTION OF DECORATIVE "UPGRADES". Replacement trim for your kitchen, bar, and bathroom. So easy to use, professional installation is not necessary.

Full range of accessories available including handles, escutcheons, tub spouts, strainers, p-traps, air-gaps, soap dispensers, and much more.

Choose from a extensive list of finishes. All designed to complement any décor.

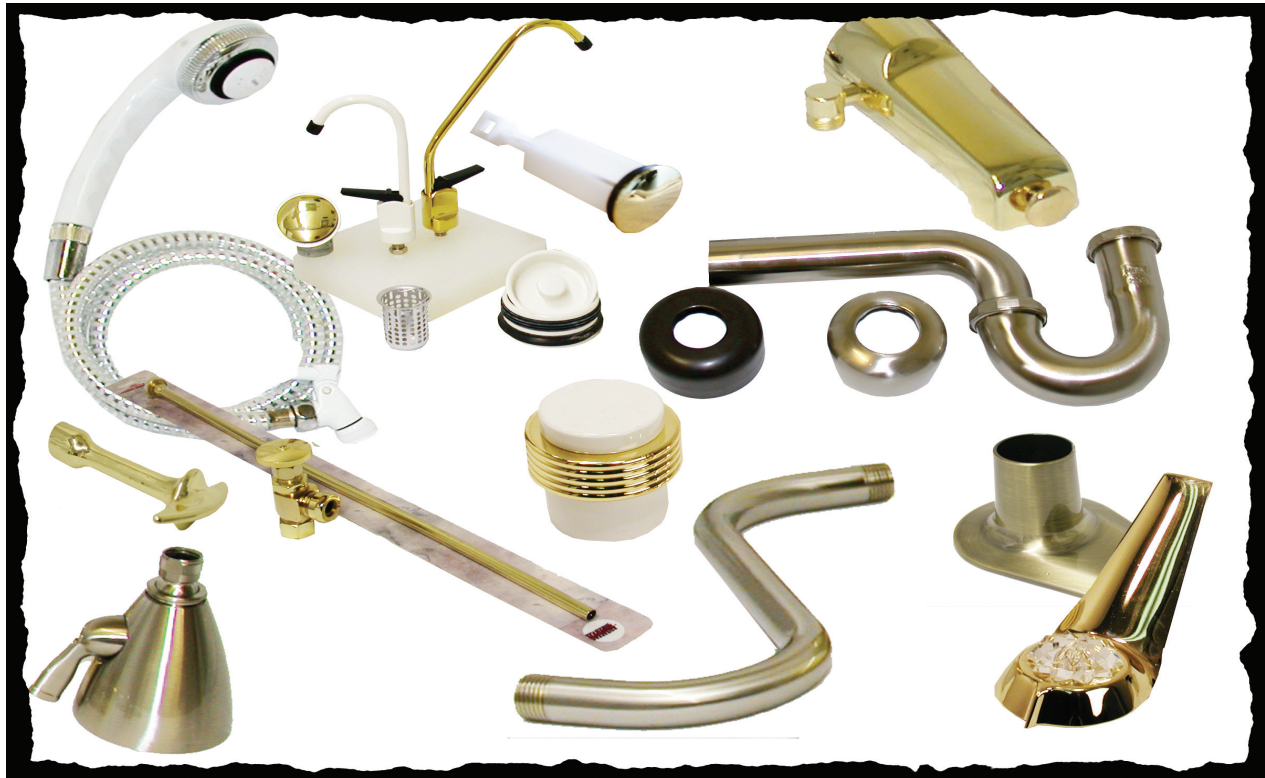

TANK LEVERS AND FLANGES



P-TRAPS



KITCHEN AND BAR



TUB AND SHOWER



STRAINERS



SHOWER ACCESSORIES





KITCHEN and BAR

BULK	CARDED	DESCRIPTION	FINISHES
------	--------	-------------	----------

AIR GAPS

30200	30201	Air Gap Kit Complete	AL•B•EU•P• SS•W•OB•SN
30202	30203	Air Gap Cap Only Short Style • Solid Brass	AL•B•EU•P• SN•SS•W•OB
	30205	Air Gap Body Only	

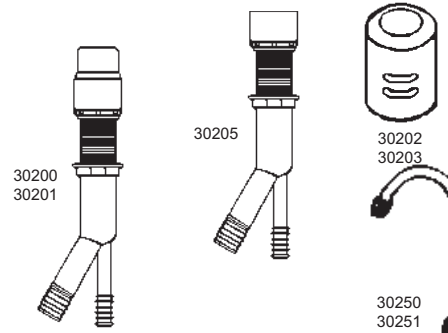

WATER DISPENSERS

30250	30251	Water Dispenser Faucet Low Lead Brass • 6"	AL•B•C•EU• P•W•OB
30260	30261	Long Reach Water Dispenser Low Lead Brass	AL•B•C•EU• P•SN•SS•W• OB
08-1336	08-1337	Chrome Plated 1/4 Turn Ceramic Faucet	
08-1338	08-1339	White 1/4 Turn Ceramic Faucet	
30250K	30251K	Water Dispenser Repair Kit	

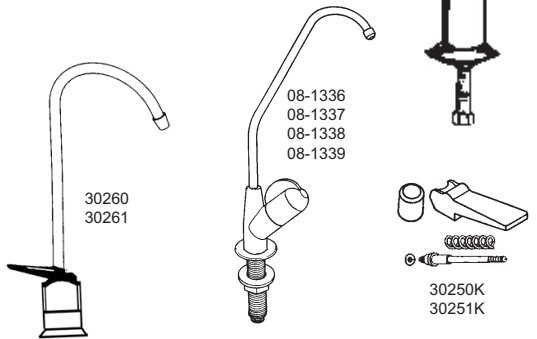

SOAP DISPENSERS

30300	30301	Soap Dispenser • Soap or Lotion	AL•B•C•EU• P•W•OB
30320	30321	Soap Dispenser • Soap or Lotion Heavy Duty • Deluxe Model	AL•C•P•SN• SS•W•OB
30330	30331	Soap Dispenser • Soap or Lotion Non-Metallic • Promotional	AL•C•P•W

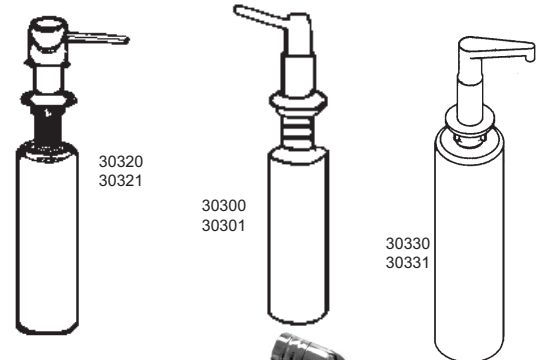

HOSE and SPRAYS

30350	30351	Kitchen Hose & Spray Kit Spray Head • 4FT. Hose • Guide	AL•W•C•SN
30352	30353	Spray Head Only	AL•W•C
30360	30361	Spray Head Only	C•SN•W
30354		4FT. Hose Only	AL•W
30356	30357	Hose Guide Only	AL•W•C•SN

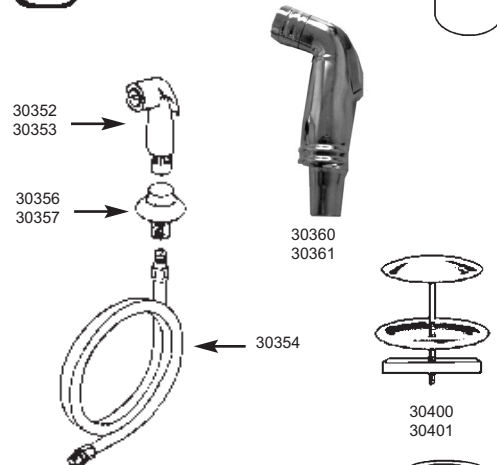

FAUCET HOLE COVER

30400	30401	Faucet Hole Cover 2" • Solid Brass	A•AL•B•C•EU P•SN•SS•W•OB
-------	-------	---------------------------------------	-----------------------------

AERATOR

91080	91081	Aerator • Deluxe Female Thread with Adapter	AL•P•SN•W
91090	91091	Swivel Aerator	OB•P•SN

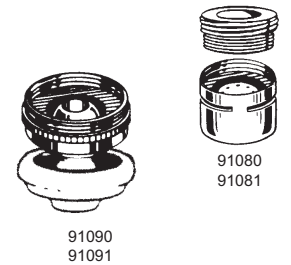

USE BULK OR CARDED NUMBER PLUS ONE OF THE FOLLOWING FINISH CODES TO INDICATE THE PART NUMBER OF THE PREFERRED FINISH:

C = Chrome P = Polished Brass W = White AL = Almond EU = Euro White B = Bone
SN = Satin Nickel SS = Stainless Steel A = Antique Bronze OB = Oil Rubbed Bronze
CW = Chrome and White CB = Chrome and Black PB = Polished Brass and Black
PW = Polished Brass and White VB = Venetian Bronze



KITCHEN and BAR

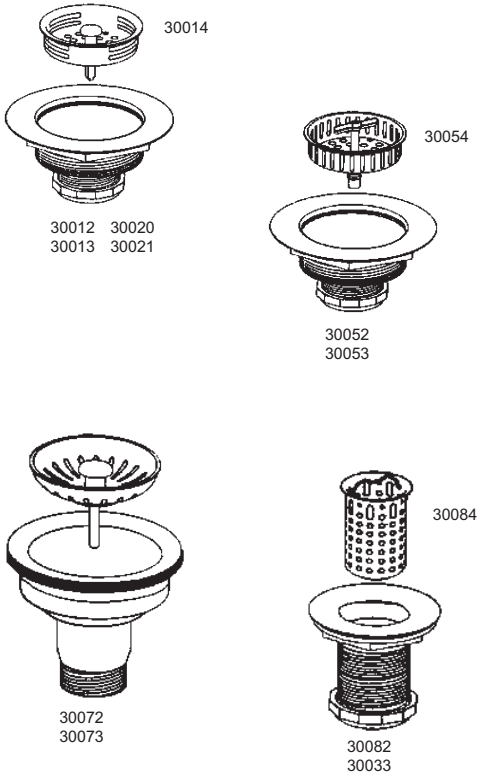

BULK	CARDED	DESCRIPTION	FINISHES
------	--------	-------------	----------

BASKET STRAINERS

30012	30013	Basket Strainer • Post Type • 3-1/2" • Solid Brass	AL•P•SS•W•OB•SN
30052	30053	Basket Strainer • Spin Type • 3-1/2" • Solid Brass	AL•P•SN•W•OB•SS
30020	30021	Heavy Duty • Kohler Style 3-1/2" • Solid Brass	P•C•SN
30072	30073	Basket Strainer • Polypropylene • 3-1/2" Post Type	AL•W
30082	30083	Bar Sink Strainer • 2" Bail Type • Solid Brass	AL•P•SS•W
30014		Replacement Basket Only • Post Type	W
30054		Replacement Basket Only • Spin Type	W
30084		Bail Strainer Only	P

DISPOSAL PARTS

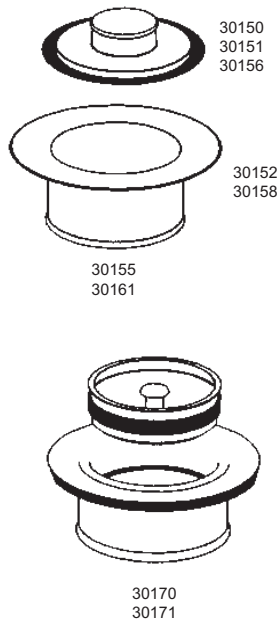

30150	30151	Stopper • Garbage Disposal in-sink-erator • Solid Brass	AL•C•P•SN•SS•W•OB
30152		Flange • Garbage Disposal in-sink-erator • Solid Brass	AL•C•P•SN•SS•W•OB
	30155	Stopper and Flange Set in-sink-erator • Solid Brass	AL•C•P•SN•SS•W•OB
30156		Stopper • Garbage Disposal Waste King • Solid Brass	AL•C•P•W
30158		Flange • Garbage Disposal Waste King • Solid Brass	AL•C•P•W
	30161	Stopper and Flange Set Waste King • Solid Brass	AL•C•P•W
30170	30171	Stopper and Flange Set Polypropylene • Universal Fit	AL•W

USE BULK OR CARDED NUMBER PLUS ONE OF THE FOLLOWING FINISH CODES TO INDICATE THE PART NUMBER OF THE PREFERRED FINISH:

C = Chrome **P** = Polished Brass **W** = White **AL** = Almond **EU** = Euro White **B** = Bone
SN = Satin Nickel **SS** = Stainless Steel **A** = Antique Bronze **OB** = Oil Rubbed Bronze
CW = Chrome and White **CB** = Chrome and Black **PB** = Polished Brass and Black
PW = Polished Brass and White **VB** = Venetian Bronze

02/04/08



BULK CARDED

DESCRIPTION

FINISHES

SHOWER STRAINERS • TILE SQUARES

31300		Tile Square • 4-1/4 x 4-1/4	A•P•SN•W•OB
31320		Crown Ring • Ring Only	A•P•SN•W•OB
31288	31289	Drain Grill with Screws 3-1/4" O.D. • 2-7/8" Hole to Hole	A•C•P•SN•W•OB
	31341	Drain Tile Square Set Tile Square • Crown Ring • Drain Grill • Screws	A•C•P•SN•W•OB
31290	31291	4" Flat Strainer 3-3/8" Hole to Hole	A•P•SN
31352	31353	3-1/4" Casper Strainer 2-7/8" Prong to Prong	A•P•SN•W
31354	31355	4-1/2" Casper Strainer 2-7/8" Prong to Prong	A•C•P•SN•W•OB
31356	31357	4-1/2" Fiat Strainer 3-1/8" Prong to Prong	A•P•SN•W•C
31350		4-1/4" AB & A Strainer 2-7/8" Prong to Prong	P•SN•C
31380	31381	3" Snap-In • 2" Pipe	A•P•SN•W
31382	31383	4" Snap-In • 3" Pipe	A•P•SN•W
31384	31385	5" Snap-In • 4" Pipe	A•P•SN•W

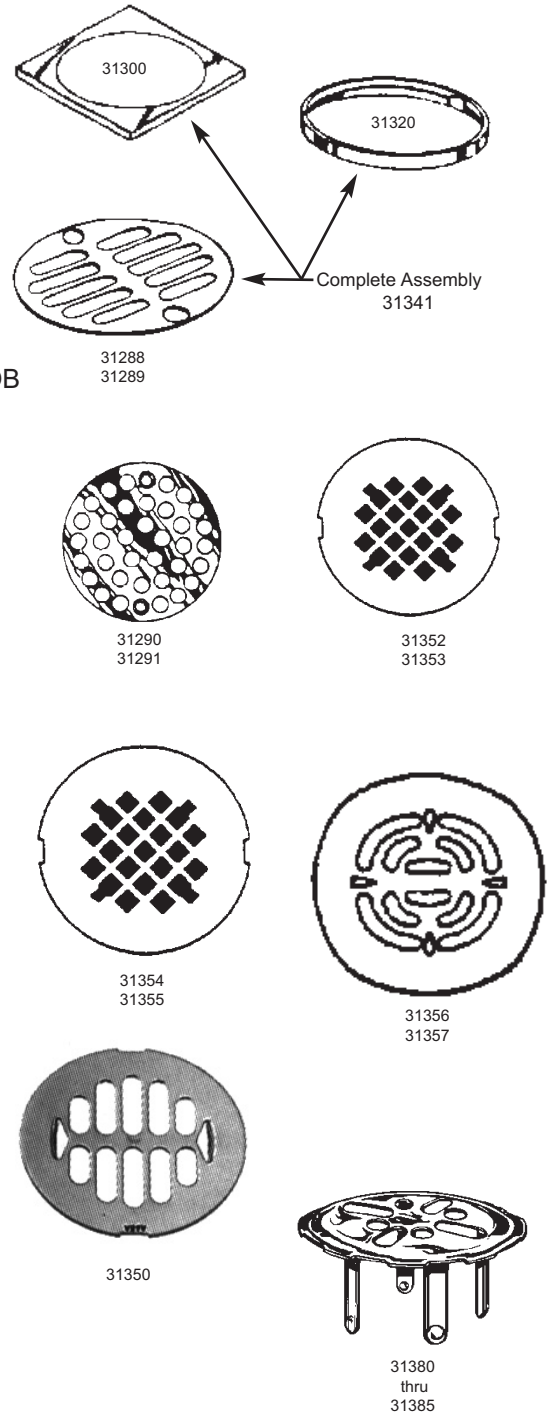

USE BULK OR CARDED NUMBER PLUS ONE OF THE FOLLOWING FINISH CODES TO INDICATE THE PART NUMBER OF THE PREFERRED FINISH:

C = Chrome **P** = Polished Brass **W** = White **AL** = Almond **EU** = Euro White **B** = Bone
SN = Satin Nickel **SS** = Stainless Steel **A** = Antique Bronze **OB** = Oil Rubbed Bronze
CW = Chrome and White **CB** = Chrome and Black **PB** = Polished Brass and Black
PW = Polished Brass and White **VB** = Venetian Bronze



TUB and SHOWER

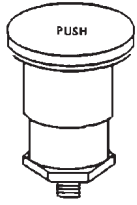

31360
31361

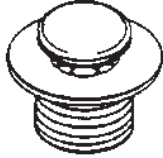

31363
31365

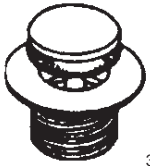

31359



34862
34863
34864
34865

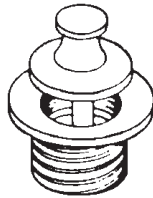

31400

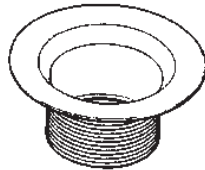

31358
31368

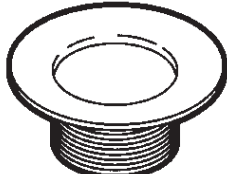

34871

BULK	CARDED	DESCRIPTION	FINISHES
------	--------	-------------	----------

TIP TOE

31360	31361	Tip Toe Replacement Cartridge Brass Top • 5/16 Thread	A•C•P•SN•W OB
	31363	Tip Toe Strainer and Stopper 1-1/4 Fine Thread • Brass Top	A•C•P•SN•W
	31365	Tip Toe Strainer and Stopper 1-1/2 Coarse Thread • Brass Top	A•C•P•SN•W
	31359	Tip Toe Strainer and Stopper 1-1/4 Fine Thread • With 1-1/2 x 1-1/4 Bushing	A•C•P•SN•W OB

LIFT and LOCK

34862	34863	Lift & Lock Stopper and Strainer 1-1/4 Fine Thread	A•C•P•W•SN
34864	34865	Lift & Lock Stopper and Strainer 1-1/2 Coarse Thread	A•C•P•W

TUB STOPPERS • STRAINERS

31400	31401	Roman Tub Drain Top Only w/Screws	C•P•SN
31358		Tub Strainer • 1-1/4 Fine Thread 5/16 Tap	A•C•P•SN•W OB
31368		Tub Strainer • 1-1/2 Coarse Thread 5/16 Tap	A•C•P•SN•W
	34871	Tub Strainer • 1-1/4 Fine Thread • Grid	A•C•P•SN•W

USE BULK OR CARDED NUMBER PLUS ONE OF THE FOLLOWING FINISH CODES TO INDICATE THE PART NUMBER OF THE PREFERRED FINISH:

C = Chrome **P** = Polished Brass **W** = White **AL** = Almond **EU** = Euro White **B** = Bone
SN = Satin Nickel **SS** = Stainless Steel **A** = Antique Bronze **OB** = Oil Rubbed Bronze
CW = Chrome and White **CB** = Chrome and Black **PB** = Polished Brass and Black
PW = Polished Brass and White **VB** = Venetian Bronze

02/04/08





TUB and SHOWER

BULK	CARDED	DESCRIPTION	FINISHES
------	--------	-------------	----------

TUB DRAIN PARTS

31592	31593	Trip Lever Plate • with Screws Round Style	A•C•P•SN•W OB
31594	31595	1 Hole Overflow Plate Solid Brass • with Screw	A•C•P•SN•W
31596	31597	2 Hole Overflow Plate Solid Brass • with Screws	A•C•P•SN•W OB
31414		Screw for Overflow Plate	A•C•P•SN•W
34868	34869	Gerber Style Strainer Top Assembly with Screw	A•C•P•SN•W OB
03-1440		Converter Bracket • 2 Hole to 1 Hole	
03-4820		1-1/2 x 1-1/4 Bushing Adapts Fine Thread Tub Drain to 1-1/2 Coarse Thread	



31593

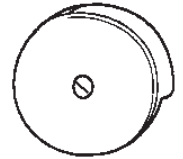

31594
31595

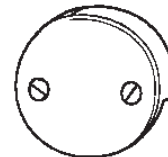

31596
31597

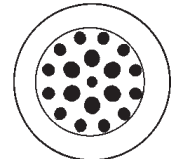

34868



31414



03-1440



03-4820

STRAINER KITS

	34851	Trip Lever with Strainer Brass Grid Strainer • With 1-1/2 x 1-1/4 Bushing	A•C•P•SN•W OB
	34859	Tip Toe Strainer Kit 1 Hole Overflow Plate with 2 Hole Converter Bracket Brass Top • 1-1/4 x 1-1/2 Bushing	A•C•P•SN•W OB
	34861	Lift & Turn Strainer Kit 1 Hole Overflow Plate with 2 Hole Converter Bracket Solid Brass • 1-1/4 x 1-1/2 Bushing	A•C•P•SN•W OB
	34899	Push & Pull Strainer Kit 1 Hole Overflow Plate with 2 Hole Converter Bracket Solid Brass • 1-1/4 x 1-1/2 Bushing	A•C•P•SN•W OB



34851

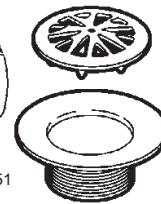

34859

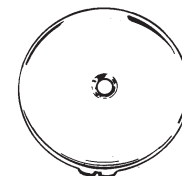
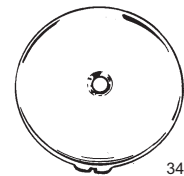

34861
34899

USE BULK OR CARDED NUMBER PLUS ONE OF THE FOLLOWING FINISH CODES TO INDICATE THE PART NUMBER OF THE PREFERRED FINISH:

C = Chrome **P** = Polished Brass **W** = White **AL** = Almond **EU** = Euro White **B** = Bone
SN = Satin Nickel **SS** = Stainless Steel **A** = Antique Bronze **OB** = Oil Rubbed Bronze
CW = Chrome and White **CB** = Chrome and Black **PB** = Polished Brass and Black
PW = Polished Brass and White **VB** = Venetian Bronze



TUB and SHOWER



82262
82282

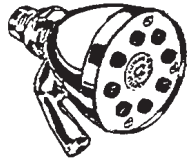

82296

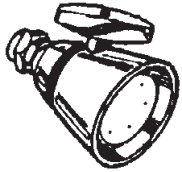

82314
82315

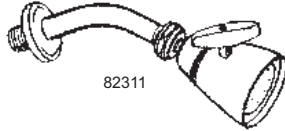

82311



82544
82545

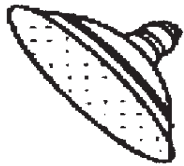

08-5551
08-5553

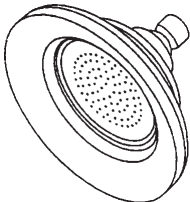

08-5574
08-5576



08-5578



08-5610

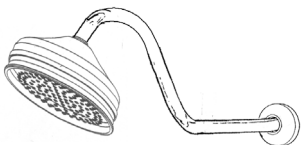

08-5590



08-5580

BULK	CARDED	DESCRIPTION	FINISHES
------	--------	-------------	----------

SHOWER HEADS

82262	82263	6 Plunger Speakman Style All Brass • 3 Inch Face	C•P•SN
82296		8 Plunger Speakman Style All Brass • 4 Inch Face	C•P•SN
82282		6 Plunger Genuine Speakman	P
82314	82315	Medium Chatham Style Solid Brass • 2-1/2" Face	A•P•W•OB• SN•C
	82311	Shower Head, Arm & Flange	A•C•P•SN
82544	82545	Brass Shower Head With Shut-Off	A•P
	08-5551	Rain Shower • Chrome Plated 5-1/4" • Head Only	Chrome Plated
	08-5553	Rain Shower • Polished Brass 5-1/4" • Head Only	Polished Brass
	08-5578	Rain Shower • Chrome Plated 5" Face • 36 Brass Jets	Chrome Plated
	08-5574	Sunshower • Chrome Plated 6-1/4" Face • Porcelain Rim	Chrome Plated
	08-5576	Sunshower • Polished Brass 6-1/4" Face • Porcelain Rim	Polished Brass
	08-5610	10" Shower Head with Brass Jets & Arm & Flange (Boxed)	Chrome Plated
	08-5580	5 Swirl Arm Shower Head	Chrome Plated
	08-5590	8" Pan Shower Head with Arm & Flange (Boxed)	Chrome Plated

USE BULK OR CARDED NUMBER PLUS ONE OF THE FOLLOWING FINISH CODES TO INDICATE THE PART NUMBER OF THE PREFERRED FINISH:

C = Chrome P = Polished Brass W = White AL = Almond EU = Euro White B = Bone
 SN = Satin Nickel SS = Stainless Steel A = Antique Bronze OB = Oil Rubbed Bronze
 CW = Chrome and White CB = Chrome and Black PB = Polished Brass and Black
 PW = Polished Brass and White VB = Venetian Bronze

02/04/08





TUB and SHOWER

BULK	CARDED	DESCRIPTION	FINISHES
------	--------	-------------	----------

ALL DIRECTIONAL SHOWER HEADS

82210	82211	All Directional Shower Head 10" Adjustable Arm • 4" Shower	A•C•P•SN•W OB
	08-5531	Rain Shower • On Adjustable Arm	Chrome Plated
	08-5533	Rain Shower • On Adjustable Arm	Polished Brass

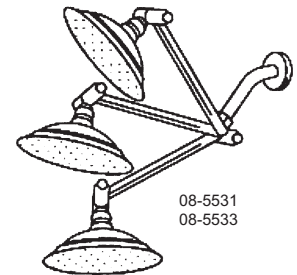
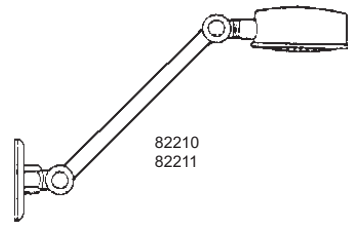

SHOWER ARMS

carded with flange • bulk less flange

82450	82451	6 Inch Brass	A•C•P•SN•W•OB
82452	82453	8 Inch Brass	A•P•SN•W•OB
82462	82463	10 Inch "S" Arm	A•C•P•SN•W•OB
82220	82221	10 Inch All Directional Swivels at both ends of arm	A•C•P•SN•W
82230		10 Inch Large Rain Shower Arm	C
31202	31203	Shower Arm Flange Brass	A•C•P•SN•W•OB
82470	82471	Volume Control • 1/2" IPS Solid Brass	A•C•P•SN•W•OB

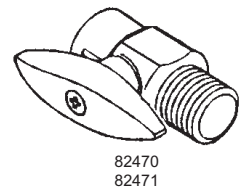
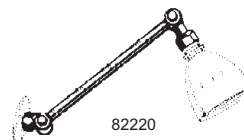
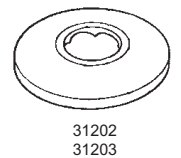
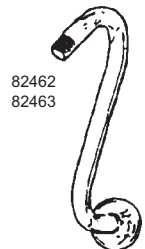
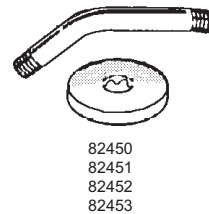

USE BULK OR CARDED NUMBER PLUS ONE OF THE FOLLOWING FINISH CODES TO INDICATE THE PART NUMBER OF THE PREFERRED FINISH:

C = Chrome **P** = Polished Brass **W** = White **AL** = Almond **EU** = Euro White **B** = Bone
SN = Satin Nickel **SS** = Stainless Steel **A** = Antique Bronze **OB** = Oil Rubbed Bronze
CW = Chrome and White **CB** = Chrome and Black **PB** = Polished Brass and Black
PW = Polished Brass and White **VB** = Venetian Bronze



TUB and SHOWER

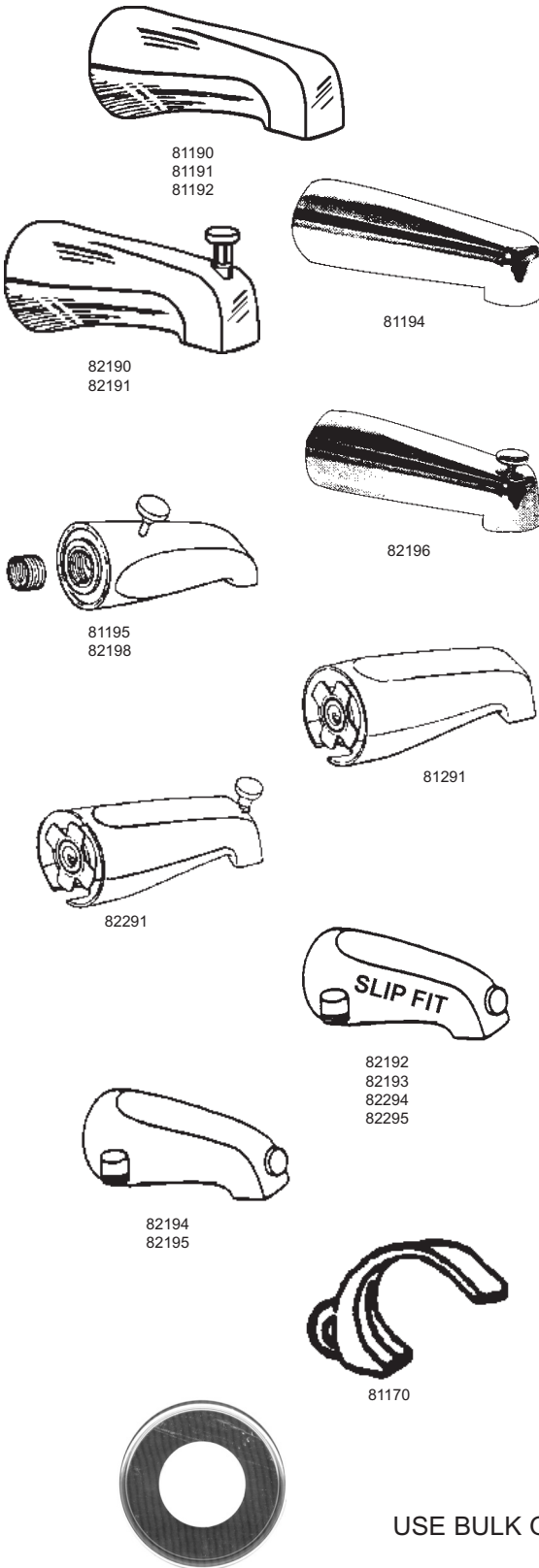

BULK	CARDED	DESCRIPTION	FINISHES
------	--------	-------------	----------

TUB SPOUTS

81190 81191 81192	81191	Regular • Front threads Solid brass • 1/2" IPS	A•C•P•SN•W•OB
82190 82191	81194	7 Inch • Extra long • Zinc • Fits IPS or Copper	P•SN
81195 82198	81192	9 Inch • Extra long Solid brass • Rear threads	C•OB•P•SN
82190 82191	82191	Diverter • Front lift Solid brass • Front threads	A•C•P•SN•W•OB
82196	82196	7 Inch • Diverter • Front lift • 4 in 1 Fits IPS or Copper	P•SN
82198	82198	9 Inch Diverter • Extra long Solid brass • Rear threads	C•OB•P
81195 82198	81195	Diverter • Rear Lift 1/2" or 3/4" • Rear threads	A•C•P•SN•W
82191	81291	Regular • Slip fit • Fits over 5/8 O.D. • (1/2 Nominal) Copper tube	A•C•P•W
82291	82291	Diverter • Slip fit • Fits over 5/8 O.D. • (1/2 Nominal) Copper tube	A•C•P•SN•W OB
82192	82193	Diverter • Slip fit with Personal shower outlet	A•C•P•SN•W
82294	82295	7" Diverter • Slip fit with Personal shower outlet	C•P
82194 82195	82195	Diverter • 1/2" IPS with Personal shower outlet	A•C•P•SN•W
81170	81170	Roman tub spout • Wall mount • "C" Style	C•P

TUB SPOUT BEAUTY RINGS

03-6011	CP Tub spout beauty ring
03-6013	PB Tub spout beauty ring
03-6015	SN Tub spout beauty ring

USE BULK OR CARDED NUMBER PLUS ONE OF THE FOLLOWING FINISH CODES TO INDICATE THE PART NUMBER OF THE PREFERRED FINISH:

C = Chrome **P** = Polished Brass **W** = White **AL** = Almond **EU** = Euro White **B** = Bone
SN = Satin Nickel **SS** = Stainless Steel **A** = Antique Bronze **OB** = Oil Rubbed Bronze
CW = Chrome and White **CB** = Chrome and Black **PB** = Polished Brass and Black
PW = Polished Brass and White **VB** = Venetian Bronze





TUB and SHOWER

BULK	CARDED	DESCRIPTION	FINISHES
------	--------	-------------	----------

PERSONAL SHOWER ACCESSORIES

84500	84501	3-Position hand shower bracket	W
84512	84513	Wall mount pin connector (Brass)	C•A•P•W•SN
84514	84515	Swivel connector (Brass)	C•A•P•W•SN
84520	84521	Shower arm mount (Brass)	C
84530	84531	Lever action diverter	C•A•P•SN•OB
84540	84541	Push-Pull diverter (Brass)	C•A•P•W•SN•OB

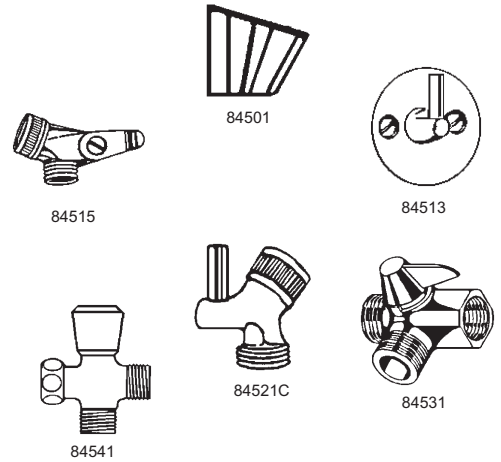

PERSONAL SHOWER HOSES

84058	84059	59 Inch vinyl hose	W
84158	84159	59 Inch hose • Stainless Steel	C
84168	84169	69 Inch hose • Stainless Steel	C
84258	84259	59 Inch hose • Voral	CB•CW•PB•PW
84358	84359	59 Inch (Brass) Double spiral hose	C•P
84368	84369	69 Inch (Brass) Double spiral hose	C•P

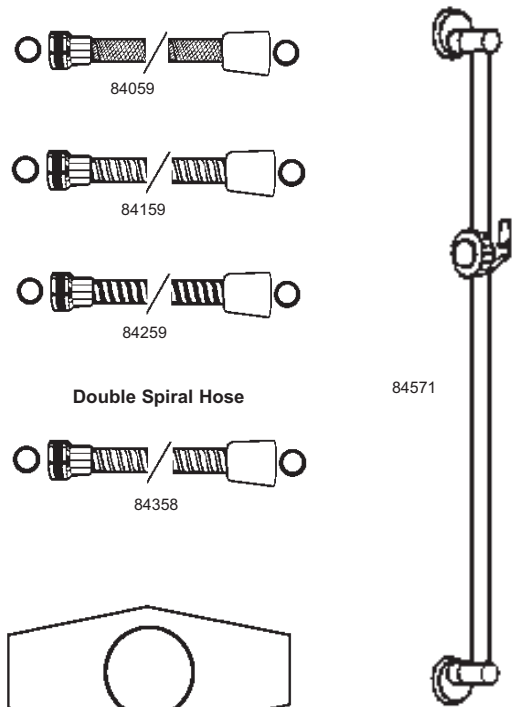

REMODEL PLATES • STAINLESS STEEL

31656	31657	1 Handle • Delta / Moen	C•P•W•SN
31652	31653	2 Handle • Delta / Moen	C•P•W
31654	31655	3 Handle • Delta / Moen	C•P•W

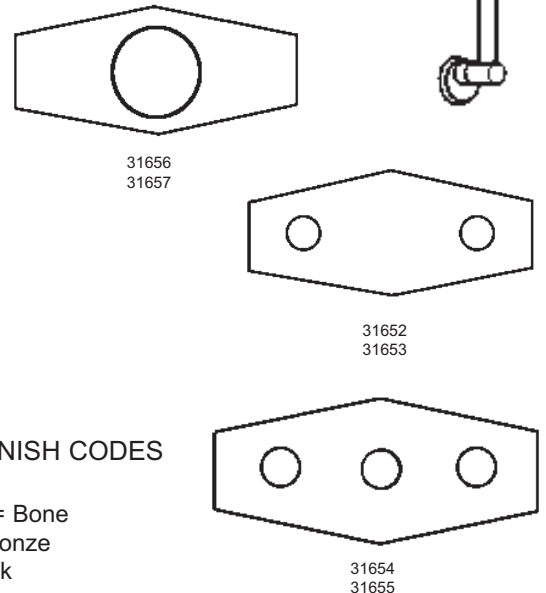

USE BULK OR CARDED NUMBER PLUS ONE OF THE FOLLOWING FINISH CODES TO INDICATE THE PART NUMBER OF THE PREFERRED FINISH:

C = Chrome **P** = Polished Brass **W** = White **AL** = Almond **EU** = Euro White **B** = Bone
SN = Satin Nickel **SS** = Stainless Steel **A** = Antique Bronze **OB** = Oil Rubbed Bronze
CW = Chrome and White **CB** = Chrome and Black **PB** = Polished Brass and Black
PW = Polished Brass and White **VB** = Venetian Bronze

02/04/08



LAVATORY & TOILET

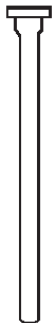
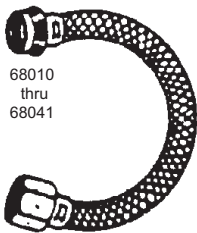
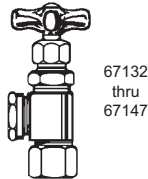
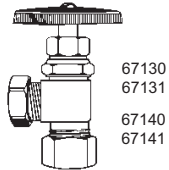
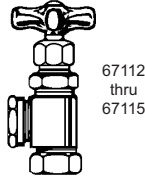
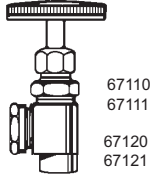

BULK CARDED DESCRIPTION FINISHES

ANGLE STOPS • HEAVY DUTY • DOUBLE STUFFING NUT

Round Brass Handle

67110	67111	1/2" IPS Inlet • 3/8 Comp Outlet	A•P•SN•W•OB
67120	67121	1/2" IPS Inlet • 7/16-1/2 Slip Joint	A•C•P•W
67130	67131	5/8" Comp Inlet • 3/8 Comp Outlet	A•P•SN•W•OB
67140	67141	5/8" Comp Inlet • 7/16-1/2 Slip Joint	A•C•P•W

Hot Cross Handle Porcelain Button

67112	67113*	1/2" IPS Inlet • 3/8 Comp Outlet	C•P•SN
67122	67123*	1/2" IPS Inlet • 7/16-1/2 Slip Joint	C•P•SN
67132	67133*	5/8" Comp Inlet • 3/8 Comp Outlet	C•P•SN
67142	67143*	5/8" Comp Inlet • 7/16-1/2 Slip Joint	C•P•SN
0-8350		Replacement Button	

*Carded 1Pair/Card • Hot/Cold

Cold Cross Handle Porcelain Button

67114	67113*	1/2" IPS Inlet • 3/8 Comp Outlet	C•P•SN
67124	67123*	1/2" IPS Inlet • 7/16-1/2 Slip Joint	C•P•SN
67134	67133*	5/8" Comp Inlet • 3/8 Comp Outlet	C•P•SN
67144	67143*	5/8" Comp Inlet • 7/16-1/2 Slip Joint	C•P•SN
0-8352		Replacement Button	

*Carded 1Pair/Card • Hot/Cold

Cross Handle Plain Metal Button

67116	67117	1/2" IPS Inlet • 3/8 Comp Outlet	C•P•SN
67126	67127	1/2" IPS Inlet • 7/16-1/2 Slip Joint	C•P•SN
67136	67137	5/8" Comp Inlet • 3/8 Comp Outlet	C•P•SN
67146	67147	5/8" Comp Inlet • 7/16-1/2 Slip Joint	C•P•SN
0-8360		CP Replacement Button	
0-8362		PB Replacement Button	
0-8364		SN Replacement Button	

FLEXIBLE SUPPLY LINES

68010	68011	3/8 Comp x Ballcock x 12"	Braided	A•P
68020	68021	3/8 Comp x Faucet x 16"	Braided	A•P
68030	68031	1/2 IPS x Ballcock x 12"	Braided	A•P
68040	68041	1/2 IPS x Faucet x 16"	Braided	A•P
68060	68061	1/2 x 12" Corrugated		A•P•W
68070	68071	1/2 x 15" Corrugated		A•P•W
68078	68079	3/8 x 12" Bullnose Riser		C•P•SN•W•OB
68080	68081	3/8 x 20" Bullnose Riser		C•P•SN•W•OB
68088	68089	3/8 x 12" Flathead Riser		C•P•SN•W•OB
68090	68091	3/8 x 20" Flathead Riser		C•P•SN•W•OB

USE BULK OR CARDED NUMBER PLUS ONE OF THE FOLLOWING FINISH CODES TO INDICATE THE PART NUMBER OF THE PREFERRED FINISH:

C = Chrome **P** = Polished Brass **W** = White **AL** = Almond **EU** = Euro White **B** = Bone
SN = Satin Nickel **SS** = Stainless Steel **A** = Antique Bronze **OB** = Oil Rubbed Bronze
CW = Chrome and White **CB** = Chrome and Black **PB** = Polished Brass and Black
PW = Polished Brass and White **VB** = Venetian Bronze

09/08/04





LAVATORY & TOILET

BULK	CARDED	DESCRIPTION	FINISHES
------	--------	-------------	----------

HOOK-UP KITS

Toilet Supply Kit

67781	1/2" IPS with 5/8" OD adapter • Heavy duty • Decorative cross handle • Angle stop with 20" corrugated riser	C•P•SN
-------	---	--------



Valve & Riser

67761	1/2" IPS x 15" Flexible Riser & Valve	A•P
67771	5/8" OD x 15" Flexible Riser and Valve	A•P

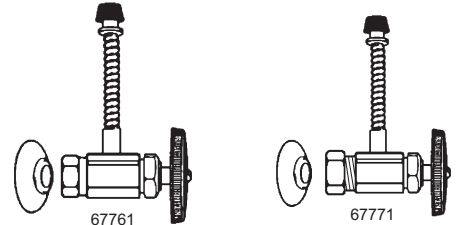

Pedestal Sink Kit

67791	Two IPS Heavy Duty Decorative Cross Handle Angle Stops with 5/8" OD Adaptors and 1-1/4" 17ga P-Trap	C•P•SN
67793	Two IPS Heavy Duty Decorative Cross Handle Angle Stops with 5/8" OD Adaptors and 1-1/2" 17ga P-Trap	C•P•SN



P-TRAPS

31002	31003	1-1/4 x 1-1/4 P-Trap 17 Gauge	P•SN•OB
31010	31011	1-1/2 x 1-1/2 P-Trap 17 Gauge	P•SN•OB

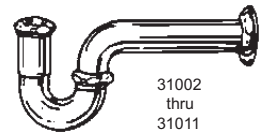

TAILPIECES • 17 GAUGE

31006	31007	1-1/4 x 12" Slip Extension	P•SN•OB•VB
31030	31031	1-1/4 x 12" Threaded Extension	P•SN•OB•VB
31036	31037	1-1/4 x 12" Flanged Tailpiece	P•SN•OB•VB



TRIP WASTE & OVERFLOW 17 GAUGE

34930	Bath Drain 17 Gauge	P•OB•SN
34932	Exposed for Roll-Rim Tub	C•P

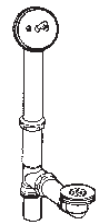
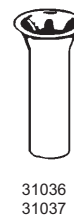

USE BULK OR CARDED NUMBER PLUS ONE OF THE FOLLOWING FINISH CODES TO INDICATE THE PART NUMBER OF THE PREFERRED FINISH:

C = Chrome **P** = Polished Brass **W** = White **AL** = Almond **EU** = Euro White **B** = Bone
SN = Satin Nickel **SS** = Stainless Steel **A** = Antique Bronze **OB** = Oil Rubbed Bronze
CW = Chrome and White **CB** = Chrome and Black **PB** = Polished Brass and Black
PW = Polished Brass and White **VB** = Venetian Bronze



MISCELLANEOUS

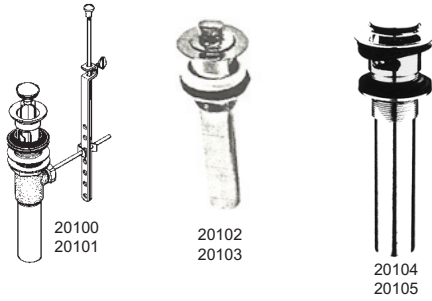

BULK	CARDED	DESCRIPTION	FINISHES
BRASS POP-UP			
20100	20101	PVD Brass Pop-Up	P•SN•OB
20102	20103	Lift & Turn • For glass vessel	C•P•SN•OB
20104	20105	Tip Toe Pop-Up L/Port	C•P•SN•OB
20106	20107	Tip Toe Pop-Up W/Port	C•P•SN•OB
20108	20109	Tip Toe Vessel Pop-Up 1-1/2"	C•P•SN•OB

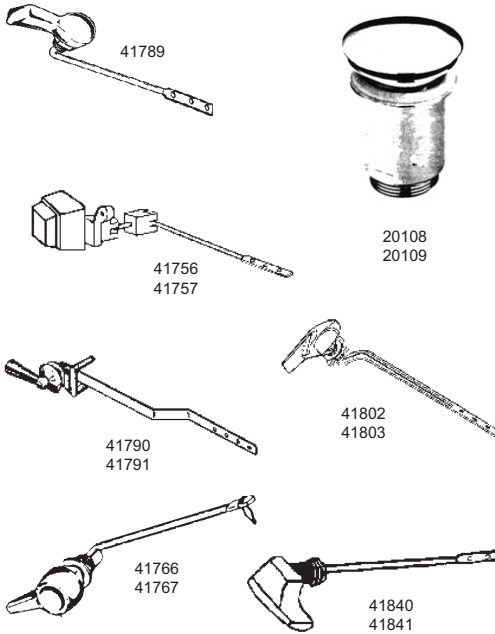

BULK	CARDED	DESCRIPTION	FINISHES
TOILET TANK LEVERS			
	41789	Standard Tank Lever	A•P•SN
41790	41791	Solid Brass Lever W/Porcelain Handle	A•C•P•OB•SN
41756	41757	Push Button Side Mount	P
41766	41767	American Standard	P
41802	41803	Kohler	P
41840	41841	Eljer	P

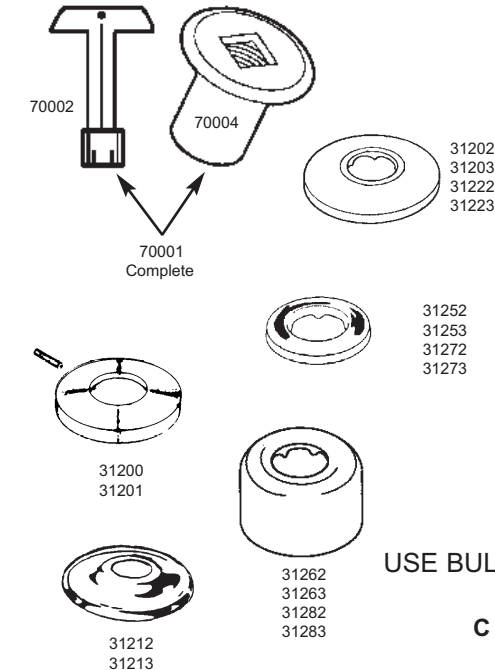

BULK	CARDED	DESCRIPTION	FINISHES
LOG LIGHTER			
70001		Log Lighter Kit (Flange and Key)	C•P•SN
70002		Log Lighter Key	C•P•SN
70004		Log Lighter Flange	C•P•SN

BULK	CARDED	DESCRIPTION	FINISHES
FLANGES			
31200	31201	1/2" Shower Arm W/Set Screw	A•P•W•SN•OB
31202	31203	1/2" Shower Arm Sure Grip	A•P•SN•W•OB
31212	31213	5/8 O.D. Sure Grip for 1/2" Copper	A•P•SN•W•OB
31222	31223	1/2 IPS for Galvanized Pipe	A•P•SN•W•OB
31252	31253	1-1/4 O.D. Sure Grip • P-Trap	P•SN•OB
31262	31263	1-1/4 Tubular x 3" O.D.	P•OB•SN
31272	31273	1-1/2 O.D. Sure Grip • P-Trap	P•OB•SN
31282	31283	1-1/2 Tubular x 3" O.D.	P•OB•SN

USE BULK OR CARDED NUMBER PLUS ONE OF THE FOLLOWING FINISH CODES TO INDICATE THE PART NUMBER OF THE PREFERRED FINISH:

C = Chrome P = Polished Brass W = White AL = Almond EU = Euro White B = Bone
 SN = Satin Nickel SS = Stainless Steel A = Antique Bronze OB = Oil Rubbed Bronze
 CW = Chrome and White CB = Chrome and Black PB = Polished Brass and Black
 PW = Polished Brass and White VB = Venetian Bronze





CARDED KITS

Flange • Beauty Ring • Key



70015 ACFB
70015 C
70015 P
70015 SN

Antique Copper/Black
Chrome Plated
Polished Brass
Satin Nickel

LOG LIGHTER FLANGE



70006FB
Flat Black



70006SN
Satin Nickel



70006C
Chrome Plated



70006P
Polished Brass

BEAUTY RINGS

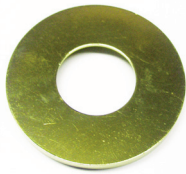

70008P
Polished Brass



70008PC
Polished Copper



70008FB
Flat Black



70008C
Chrome Plated



70008AC
Antique Copper



70008AP
Antique Pewter



70008SB
Satin Brass



SINGLE LEVER



TRIM SET INCLUDES:

Escutcheon • Sleeve • Retainer Cap • Handle • Screws • Adjusting Ring

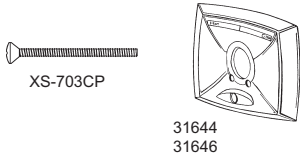
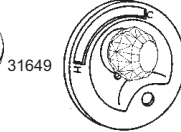
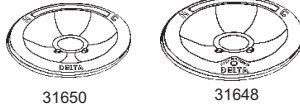

TRIM SET INCLUDES:

5-1/2" Escutcheon • Retainer Nut • Round and Lever Handle

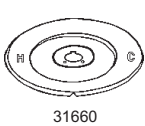
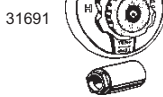

CHATEAU TRIM SET INCLUDES:

Escutcheon • Tube • Handle • Screws

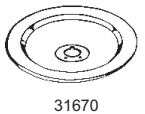

LEGEND TRIM SET INCLUDES:

Escutcheon • Tube • Handle • Screws

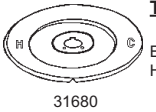

LEGEND w/ DIVERTER TRIM SET INCLUDES:

Escutcheon • Tube • Handle • Screws • Diverter

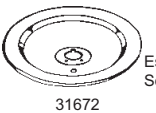
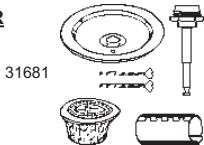

POSI-TEMP TRIM SET INCLUDES:

Escutcheon • Tube • Handle • Screws

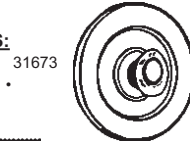

AVANTE TRIM SET INCLUDES:

Escutcheon • Tube • Handle • Screws



VALLEY TRIM SET INCLUDES:

Escutcheon • Tube • Handle • Screws • Bonnet Nut



BULK	CARDED	DESCRIPTION	FINISHES
------	--------	-------------	----------

TRIM SETS FOR DELTA • SOLID BRASS ESCUTCHEON

	31651	Standard Escutcheon • Trim Set	A•AL•C•P SN•W•OB
31650	31649	Diverter Escutcheon • Trim Set	C•P
31648		Standard Escutcheon Only	C•P
31644		Diverter Escutcheon Only	C•P
31646		Scald Guard Escutcheon Only	C•P
XS-703CP		Scald Guard Diverter Escutcheon Only	C•P
		Screw 10-24 x 2-1/2	

TRIM SETS FOR MIXET • SOLID BRASS ESCUTCHEON

	31691	Mixet 5-1/2 Inch • Trim Set	A•AL•C•P SN•W•OB
--	-------	-----------------------------	---------------------

TRIM SETS FOR MOEN • SOLID BRASS ESCUTCHEON

	31661	Chateau • Trim Set	A•AL•C•P SN•W•OB
	31671	Legend • Trim Set	A•AL•C•P SN•W•OB
	31681	Legend Diverter • Trim Set	A•C•P•W•SN
	31673	Posi-Temp • Trim Set	C•P
	31660	Chateau Escutcheon Only	C•P
	31670	Legend Escutcheon Only	C•P
	31680	Legend Diverter Escutcheon Only	C•P•SN
	31672	Posi-Temp Escutcheon Only	C•P
	31682	Posi-Temp Diverter Escutcheon Only	C•P
	XS-700S	Screw	

TRIM SETS FOR PRICE PFISTER

	31641	Avante Trim Set	A•AL•C•P SN•W•OB
XS-515		Screw	

TRIM SETS FOR VALLEY • SOLID BRASS ESCUTCHEON

	31631	Valley • Trim Set	A•C•P•SN•W•OB
--	-------	-------------------	---------------

USE BULK OR CARDED NUMBER PLUS ONE OF THE FOLLOWING FINISH CODES TO INDICATE THE PART NUMBER OF THE PREFERRED FINISH:

C = Chrome P = Polished Brass W = White AL = Almond EU = Euro White B = Bone
 SN = Satin Nickel SS = Stainless Steel A = Antique Bronze OB = Oil Rubbed Bronze
 CW = Chrome and White CB = Chrome and Black PB = Polished Brass and Black
 PW = Polished Brass and White VB = Venetian Bronze





ADAPT-A-HANDLES

BULK	CARDED	DESCRIPTION	FINISHES
------	--------	-------------	----------

ADAPT-A- CROSS HANDLES

Bulk includes handle only: Card includes - small size (2) handles (1) each hot and cold buttons (2) each 10/24 and 8/32 screws (2) sets SIMPATICO stem broach adapters: large size (1) handle (1) cold button (1) hot button (1) diverter button (1) each 10/24 and 8/32 screws (1) set of SIMPATICO stem broach adapters

19220	19221	Porcelain Cross, with solid Brass Trim (Small)	A•C•P
19230	19231	Porcelain Cross, with solid Brass Trim (Large)	A•C•P

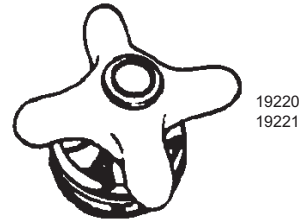

ADAPT-A- LEVER HANDLES

Bulk includes handle only: Card includes - (1) handle (1) 10/24 and 8/32 Screws (1) set of SIMPATICO stem broach adapters

19240	19241	Porcelain Lever, with solid Brass Trim	A•C•P
19250	19251	Solid Brass Lever, with Brass Trim	A•C•P•SN
19260	19261	Wood Lever, with solid Brass Trim	A•C•P



ADAPT-A- ASTRAL HANDLES

Bulk includes handle only: Card includes -small size (2) handles (2) each 10/24 and 8/32 screws (2) sets of SIMPATICO stem broach adapters: large size (1) handle (1) each 10/24 and 8/32 screws (1) set of SIMPATICO stem broach adapters

19700	19701	Grooved Ring, Solid Brass (Large)	CP•WC•WP
-------	-------	-----------------------------------	----------

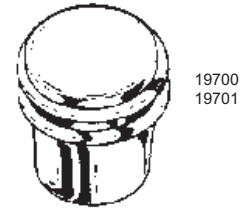

PRICE PFISTER HANDLE

41776	41777	Flowmatic Handle	P
-------	-------	------------------	---

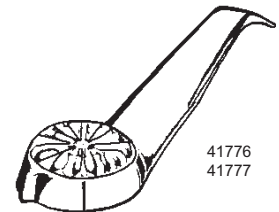

USE BULK OR CARDED NUMBER PLUS ONE OF THE FOLLOWING FINISH CODES TO INDICATE THE PART NUMBER OF THE PREFERRED FINISH:

C = Chrome **P** = Polished Brass **W** = White **AL** = Almond **EU** = Euro White **B** = Bone
SN = Satin Nickel **SS** = Stainless Steel **A** = Antique Bronze **OB** = Oil Rubbed Bronze
CW = Chrome and White **CB** = Chrome and Black **PB** = Polished Brass and Black
PW = Polished Brass and White **VB** = Venetian Bronze



ADAPT-A-HANDLES



BULK	CARDED	DESCRIPTION	FINISHES
------	--------	-------------	----------

ACCESSORIES fits both ADAPT-A-HANDLE and ADAPT-A-LEVER

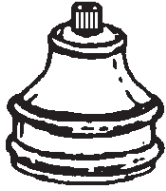

19310
thru
19321

19310	19311	Small Base, Solid Brass	A•C•P
19320	19321	Large Base, Solid Brass	A•C•P•SN
19390	19391	Base Extension, extends Large Base 3/4"	A•C•P

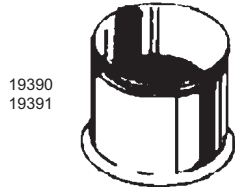

19390
19391

BROACH ADAPTERS

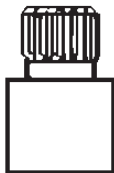

19300
thru
19510

19300	19301	Broach Adapters, Set of 12 for One Handle (Plastic)	
19500	19501	Broach Adapter, Solid Brass fits Sterling	
19502	19503	Broach Adapter, Solid Brass fits Aqua Seal	
19504	19505	Broach Adapter, Solid Brass fits Sayco & Gerber	
19506	19507	Broach Adapter, Solid Brass fits Union Brass & Briggs	
19508	19509	Broach Adapter, Solid Brass fits American Brass & Streamway	
19510	19511	Broach Adapter, Solid Brass fits Eljer & Central • 19501-19511 Carded in Pairs	

CUT-OFF SCREWS



XS-520
XS-530

XS-520		10/24, Can be cut to 1-3/4", 1-1/4", 7/8" and 1/2"	A•C•P
XS-530		8/32, Can be cut to 1-3/4", 1-1/4", 7/8" and 1/2"	A•C•P

USE BULK OR CARDED NUMBER PLUS ONE OF THE FOLLOWING FINISH CODES TO INDICATE THE PART NUMBER OF THE PREFERRED FINISH:

C = Chrome **P** = Polished Brass **W** = White **AL** = Almond **EU** = Euro White **B** = Bone
SN = Satin Nickel **SS** = Stainless Steel **A** = Antique Bronze **OB** = Oil Rubbed Bronze
CW = Chrome and White **CB** = Chrome and Black **PB** = Polished Brass and Black
PW = Polished Brass and White **VB** = Venetian Bronze

02/04/08



BULK	CARDED	DESCRIPTION	FINISHES
------	--------	-------------	----------

Adapt-A-Escutcheons : Bulk includes escutcheon only: Card includes escutcheon and (1) Fit-all nipple

ESCUTCHEONS

31510	31511	Porcelain, Solid Brass Trim	A•C•P
	31521	Fit-All, Large, Metal Adjustable 2 Piece	A•C•P•W•SN
31530	31531	Fit-All, Small Metal for Tub & Shower, also fits Price Pfister Widespread 1-1/4" Tall	A•C•P•W
	31625	Price Pfister Tub & Shower Flange	P•SN
31626	31627	Price Pfister, for Screw Driver Stop	P
31628	31629	Auqa Seal, 2 Piece, Flange & Tube	P
31550	31551	2 Piece, fits Price Pfister Crown Imperial. Will fit Amer Std, Colony, Harcraft, Eljer, Kohler, Fits Shoreham when used along with the corresponding adapter below.	A•C•P•W•SN•OB
31570	31571	Same as above New Style	C•P•SN•OB

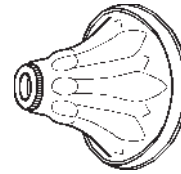

31510
31511

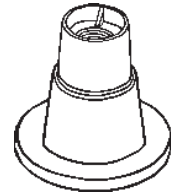

31521

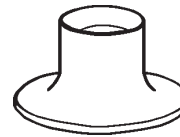

31530
31531

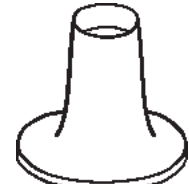

31625



31626
31627



31628
31629

ESCUTCHEON ADAPTERS

To be used with 31550/31551 (above) 2 piece sliding escutcheon. Bulk includes (1) Carded includes (2) each

31552	Price Pfister with Plastic Fit-All Nipple
31554	American Standard Colony
31556	Harcraft
31558	Eljer
31560	Kohler Shoreham/Trend

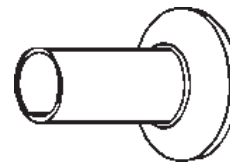

31550
31551

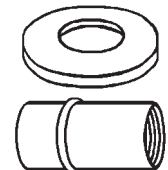

31571

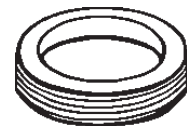

31552
thru
31560

USE BULK OR CARDED NUMBER PLUS ONE OF THE FOLLOWING FINISH CODES TO INDICATE THE PART NUMBER OF THE PREFERRED FINISH:

C = Chrome **P** = Polished Brass **W** = White **AL** = Almond **EU** = Euro White **B** = Bone
SN = Satin Nickel **SS** = Stainless Steel **A** = Antique Bronze **OB** = Oil Rubbed Bronze
CW = Chrome and White **CB** = Chrome and Black **PB** = Polished Brass and Black
PW = Polished Brass and White **VB** = Venetian Bronze



